

Blind Rivet Nuts (Inserts) Flat Head

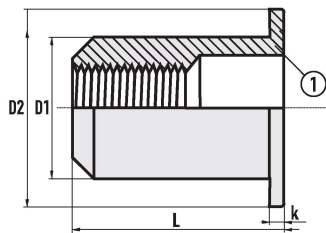

Round shank
open type

① Aluminium AlMg 3.5

M 4

D1 = 5,9 mm
D2 = 9 +/- 0,3 mm
k = 0,8 +/- 0,2 mm
L = +/- 0,2 mm
 = 6 mm

M4 X 11,0 mm	0,5 - 2,0 mm	PYL M4X11.0	250	2,3 Nm	1530 N	3020 N	
M4 X 13,0 mm	2,0 - 3,5 mm	PYL M4X13.0	250				

M 5

D1 = 6,9 mm
D2 = 10 +/- 0,3 mm
k = 1,0 +/- 0,2 mm
L = +/- 0,2 mm
 = 7 mm

M5 X 13,0 mm	0,5 - 2,5 mm	PYL M5X13.0	250	5,5 Nm	1590 N	5720 N	
M5 X 15,0 mm	2,5 - 4,0 mm	PYL M5X15.0	250				

M 6

D1 = 8,9 mm
D2 = 12,7 +/- 0,3 mm
k = 1,0 +/- 0,2 mm
L = +/- 0,2 mm
 = 9 mm

M6 X 15,0 mm	1,0 - 2,5 mm	PYL M6X15.0	250	8,5 Nm	2600 N	8470 N	
M6 X 17,0 mm	2,5 - 4,0 mm	PYL M6X17.0	250				

M 8

D1 = 10,9 mm
D2 = 15 +/- 0,3 mm
k = 1,5 +/- 0,2 mm
L = +/- 0,2 mm
 = 11 mm

M8 X 17,0 mm	0,5 - 3,0 mm	PYL M8X17.0	250	14,8 Nm	2920 N	13000 N	
M8 X 19,0 mm	3,0 - 5,0 mm	PYL M8X19.0	250				

M 10

D1 = 11,9 mm
D2 = 16 +/- 0,3 mm
k = 1,5 +/- 0,2 mm
L = +/- 0,2 mm
 = 12 mm

M10 X 19,0 mm	2,5 - 4,0 mm	PYL M10X19.0	250	20,1 Nm	4850 N	16000 N	
M10 X 21,0 mm	3,5 - 5,5 mm	PYL M10X21.0	250				

Note: D1=12.9 mm also available upon request.